

AFGRI Devon Opberging/Bunker Project

6 bunkers minimum capacity of 4500 m³

Total capacity 27,000 m³

2,4m Yfels – 748 straight units

2,4m Yfel – 24 x 135 degree corner units

24 Connector Plates

ORIGINAL BOUNDARY

BM 2 (DBM2) 1005.20

8332

561

1000

561

1000

561

CONTROL BOUNDARY

345

561

2121

561

1000

561

ORIGINAL BOUNDARY

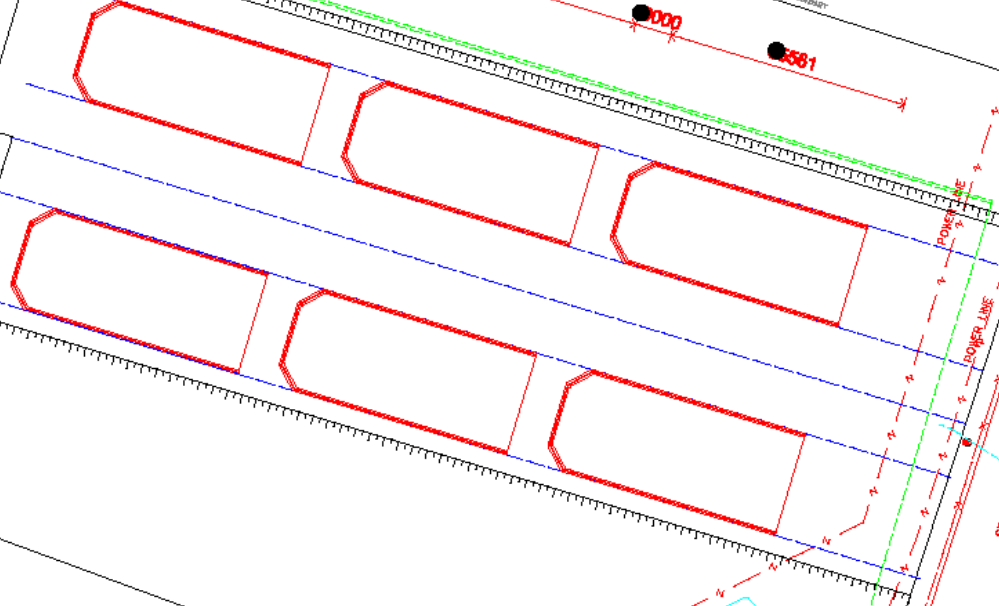

BM 1 (SK1) 1006.57

SILO'S

STONE

POWER LINE

POWER LINE

2013 sign parking and turning area

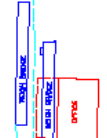

AFGRI Covered



Internal bunker view



Internal bunker view



Maize pumped into YFEL bunker



Side view – complete installation



Summary

- Total capacity = 27,000 m³
- 6 Bunkers
- Supplied for under R2,8m excluding VAT delivered using crane trucks and put directly into place.
- Supplied in less than 80 working days.
- Bunkers available for moving to new site and easily broken down.
- Installation not permanent
- No on-site personnel involved once the ground was prepared for placement of the Yfels.